

Patient information

Hearing Aid Instructions: GN ReSound UP977 / 88

Your hearing aid(s)

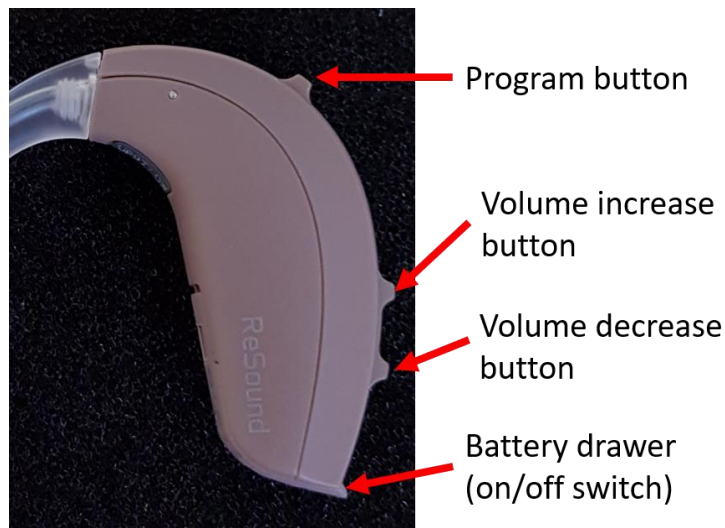

Your hearing aids have been set up:

- With a manual volume control
- With programs for different listening environments
- As full automatic. The hearing aid automatically adjusts the sound it provides in response to the environment

Identifying the left and right hearing aid

Inside the battery compartment is a red or blue dot.

If you find it difficult to visualise the colour markers, please tell the Audiologist as they can suggest alternative identification markers.

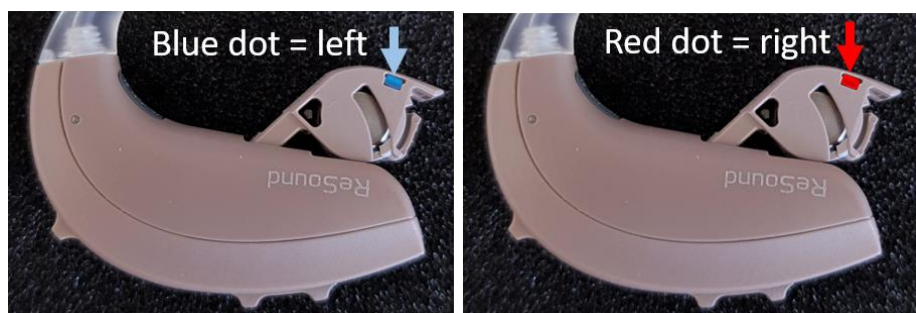

Turning the hearing aid on and off

Shut the battery drawer to turn the hearing aid on.

Open the battery drawer to turn the hearing aid off.

Remember to open the battery drawer when you are not wearing the hearing aid.



Changing the hearing aid battery

Each hearing aid requires a size 13 battery.

Each battery will last approximately 10 to 12 days. The hearing aid will give warning beep when the battery needs changing.

Remove the orange sticker from the positive side of a new battery.

The positive side is shiny and engraved with four dimples and a plus sign.



Insert the battery with the positive side facing upwards.

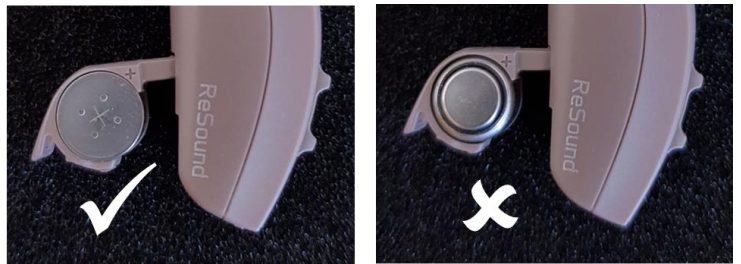

Hearing Aid Programs

Your hearing aid(s) has been set up with different programs: YES / NO

Your hearing aid(s) will switch on in program 1.

Pressing the program button will switch the hearing aid to the next program.

Your hearing aids are wirelessly linked, so changing the program on one aid will automatically be copied to the other aid without you having to touch it.

Your hearing aid(s) has the following programs:

Program 1 '1 beep'.

Program 2 '2 beep'

Program 3 '3 beeps'

Program 4 '4 beeps'



Press on the program button to change the program

Volume control

Your hearing aid(s) have a volume control: YES / NO

Use the rocker switch to adjust the volume.

Your hearing aid(s) have a volume range ofsteps.

Your hearing aid(s) will always switch on at the middle volume level.

The volume controls of your right and left hearing aids are:

- Wirelessly linked: changing the volume on one aid will automatically be copied to the other aid.
- Separate: the volume control switch will need to be pressed on both hearing aids to change the volume in both.



Press on the top of the rocker button to increase the volume

Press on the bottom of the rocker button to decrease the volume

Audiology Department Contact Details

Telephone number: 01323 413 783

Email: esht.audiology@nhs.net

Important information

This patient information is for guidance purposes only and is not provided to replace professional clinical advice from a qualified practitioner.

Your comments

We are always interested to hear your views about our leaflets. If you have any comments, please contact the Patient Experience Team – Tel: (01323) 417400 Ext: 5860 or by email at: esh-tr.patientexperience@nhs.net

Other formats

If you require any of the Trust leaflets in alternative formats, such as large print or alternative languages, please contact the Equality and Human Rights Department.

Tel: (01424) 755255 Ext: 2620

Reference

The following clinicians have been consulted and agreed this patient information:

Ian Woodward (Service Manager), Kate Bull (Clinical Lead)

Audiology Department have agreed this patient information leaflet.

Next review date: February 2022

Responsible clinician/author: Ian Woodward (Service Manager), Kate Bull (Clinical Lead)